

DUDLEY METROPOLITAN BOROUGHLOCAL GOVERNMENT (MISCELLANEOUS PROVISIONS) ACT, 1982APPLICATION FOR CONSENT TO ENGAGE IN STREET TRADING

I hereby make application to the Borough Council of Dudley for consent to engage in street trading in the manner hereunder stated. I enclose the appropriate fee of £546.00 for the first or only site for which I have applied and £546 for each additional site for which I have applied.

1.	Full name(s) of applicant(s) ^(a)	JOHN PASCAL SOMERVILLE
2.	Age(s) ^(b)	52
3.	Full-time occupation(s) ^(b)	SAT-SUN MARKET TRADER MON-FRI WARRANTY ADMIN.
4.	Full address(es) (in the case of a company address of registered office is required)	86 HARVEST ROAD SMETHWICK WEST MIDS B64 6NG
5.	Normal business address (if different)	
6.	Type of articles sold or intended to be sold ^(c)	KEY CUTTING
7.	Address(es) of place(s) where articles are or will be stored prior to being sold ^(c) (In the case of ice cream, state where it will be made)	86 HARVEST ROAD SMETHWICK WEST MIDS B64 6NG
8.	Address(es) of places where any vehicle(s) (including any motor vehicle) or any receptacle(s) (e.g. news vendor's stand or shelter used or intended to be used for the sale of any article is/are or is/are to be kept when not so used ^(c))	86 HARVEST ROAD SMETHWICK WEST MIDS B64 6NG

9.	Registration number, make and full description (including livery, height, width and length) of each motor vehicle used or intended to be used for the sale of any article ^(c)	S631XOL FORD ESCORT DIESEL WHITE VAN L-13' W-5'4" H-5'3" PHOTOS INCLUDED
10.	Full description (including livery, width and length) of each vehicle (other than a motor vehicle) and/or each receptacle used or intended to be used for the sale of any article ^(c)	N/A
11.	Full name and address of the owner (if not the applicant) of each vehicle (other than a motor vehicle) or receptacle used or intended to be used for the sale of any article ^(c)	N/A
12.	Full name(s) and address(es) of the legal owner(s) and (if different) registered owner(s) of each vehicle used or intended to be used for the sale of any article ^(c)	N/A
13.	Is it the intention to use any vehicle to which this application applies for the purpose of the sale of any article in all streets in which the consent of the Council to engage in street trading is required at the date hereunder stated? ^{(c)(d)} Please answer yes or no	NO ONLY A STATIC POSITION IF GRANTED BY THE COUNCIL
14.	If the answer to the foregoing question is yes, is it your normal trading practice or the normal trading practice of the company or firm on whose behalf you have made this application to move from place to place in or with a vehicle and sell articles from the vehicle at such places as it is halted? ^(c) Please answer yes or no (Note: If the answer to this question is yes, please ignore Question 15 below)	N/A

15.	Exact situation and dimensions of EACH site desired including name(s) of street(s) and position(s) or place(s) in street(s) where it is desired to trade ^(d) (A sketch map must be supplied of EACH site)	I HAVE INCLUDED A SKETCH OF THE MARKET AREA OF WHICH ANY SECTION YOU MAY APPROVE OF
16.	Days and times it is desired to trade	MON-SAT 9.00am - 5.00pm
17.	Are you, or is the company or firm on whose behalf you have made this application, trading on the site(s) applied for or, if the answer to Question 14 is yes, in the manner described in that question? If the answer is no, please state where and how you or the company or firm concerned are at present trading	N/A
18.	Total number of persons to be employed in street trading under any consent granted by the Council in pursuance of this application and the full names and addresses of such persons	2 MYSELF AND PARTNER
19.	What means are, or are to be, adopted for dealing with litter arising during the course of trading and for the collection and disposal of such litter?	ANY LITTER WILL BE REMOVED BY MYSELF AT THE END OF EACH WORKING DAY
20.	State any facts which you wish to be brought to the attention of the Council in support of this application.	I CAN OFFER A VERY AFFORDABLE, RELIABLE SERVICE, WHICH I BELIEVE COULD TEMPT MORE PEOPLE TO THE TOWN CENTRE

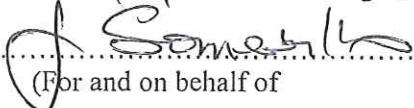
DATED this 19 day of OCTOBER 199 2009

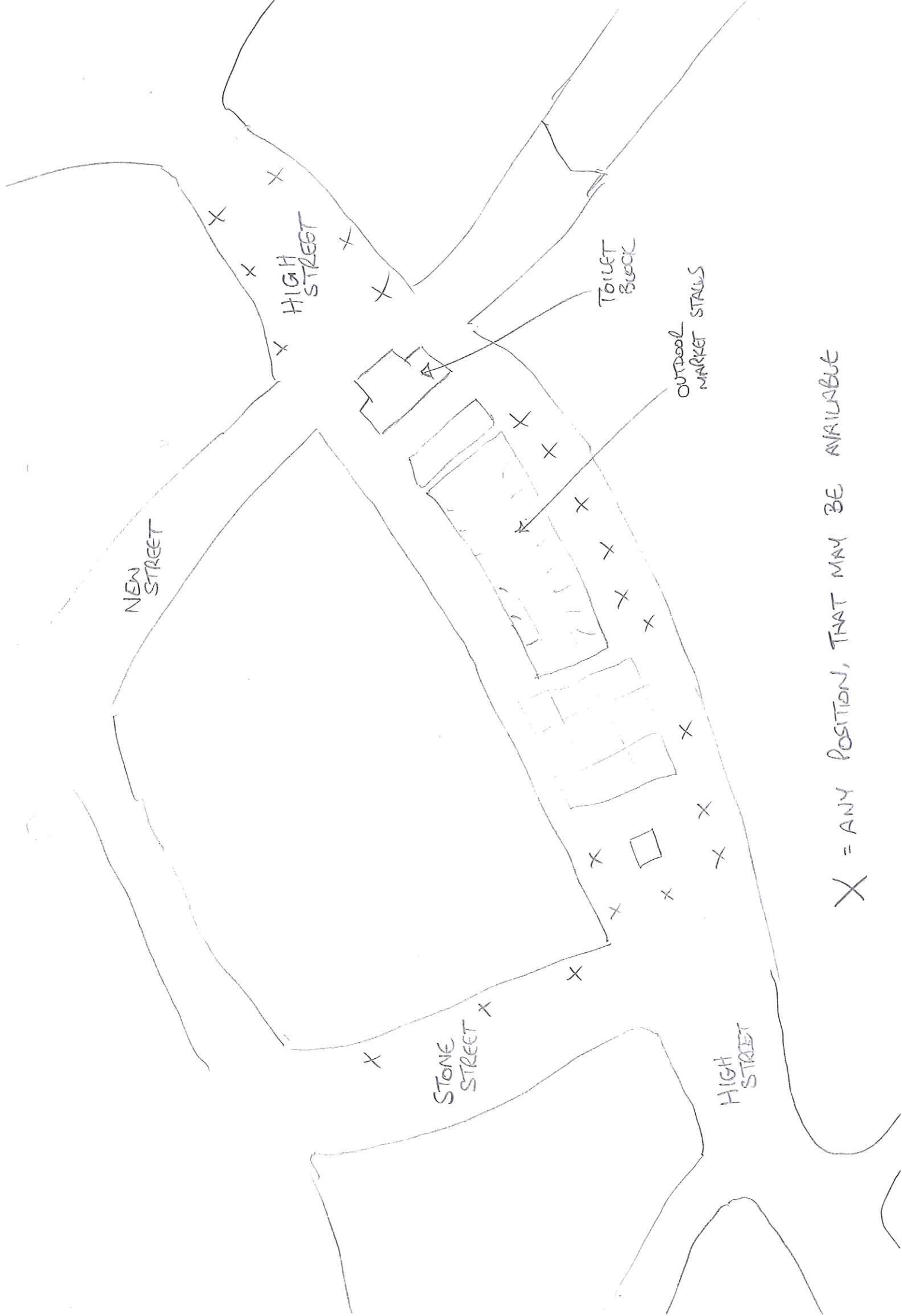
 (For and on behalf of)^(e)



X = ANY POSITION, THAT MAY BE AVAILABLE



Key Cutting



Coloured Caps & Labels



Car Keys



Mortice Keys



Cylinder Keys

Key Cutting



Coloured Caps & Labels



Car Keys



Mortice Keys



Cylinder Keys

Key Cutting	From £1	From £1-00	From £2-00	From £2-50	From 15p
Coloured Caps & Labels					
Car Keys					
Mortice Keys					
Cylinder Keys					
Steel Mortice Keys					
Coloured caps & labels					



Key Cutting

Coloured caps & Labels	Car Keys
From £2-50	From 15p

Coloured caps & Labels	Car Keys
From £2-50	From 15p

Key Cutting From £1

Coloured caps & Labels	Car Keys
From £2-50	From 15p

Key Cutting From £1

Coloured caps & Labels	Car Keys
From £2-50	From 15p

CASH ON DELIVERY

Key Cutting

Cylinder Keys



Mortice Keys



Coloured Caps & Labels



Car Keys



Key Cutting

From £1

Brass Mortice
Keys

From
£2-50

Cylinder Keys

From
£1-00

Steel Mortice
Keys

From
£2-00

Car Keys

From
£2-50

Coloured caps
& labels

From
15p

M.O.T. PARKING

Key Cutting

Cylinder Keys



Mortice Keys



Coloured Caps & Labels



Car Keys





Key Cutting

Cylinder Keys

Mortice Keys



Coloured Caps & Labels



Car Keys

Mortice Keys



Cylinder Keys

Mortice Keys



Coloured Caps & Labels



Car Keys



Key Cutting

Cylinder Keys

Mortice Keys



Coloured Caps & Labels



Car Keys



Key Cutting

From £1

Brass Mortice Keys

From £2-50

Cylinder Keys

From £1-00

Steel Mortice Keys

From £2-00

Car Keys

From £2-50

Coloured caps & labels

From 15p

