

Dear Sirs

RE: APPLICATION FOR CONVERSION/NEW/VARIATION/TRANSFER OF GAMING MACHINE PERMIT (LPN AND LPGMP) – GAMBLING ACT 2005

I wish to confirm that Town and County Leisure LTD of Unit 6, Long Acre Trading Estate, Long Acre, Birmingham, B7 5JD are authorised to act as the agent of this Company with regard Permit applications and notifications enabling the operation of Gaming machines on our premises.

I confirm that I have been provided with a summary of the Code of Practice as laid down in the Gambling Act and understand that Premises Licence Holders are responsible for ensuring that each Site upholds this.

Yours faithfully

*Timothy S. Cox*  
.....

Signed

TIMOTHY S. COX  
.....

Print

**NOTIFICATION OF 2 OR LESS GAMING MACHINES or  
GAMING MACHINE PERMIT APPLICATIONS (i.e. for greater than 2 machines) for:  
CONVERSION / NEW / VARIATION / TRANSFER**

**(FOR USE BY PREMISES LICENSED TO SUPPLY ALCOHOL FOR CONSUMPTION ON  
THE PREMISES)**

Please refer to guidance notes at the back of this form before completing

<p><b>SECTION A – What do you want to do?</b></p> <p>1. Please indicate what you would like to do</p> <p>a) Notify licensing authority that you intend to provide up to a maximum total of 2 gaming machines category C and / or D <i>(if you choose this option then please complete sections D and E)</i></p> <p>b) Apply to convert an existing Section 34 permit issued under the Gaming Act 1968, into a licensed premises gaming machine permit (i.e. for more than 2 gaming machines) <i>(if you choose this option then please complete sections B, D and E)</i></p> <p>c) Apply for a new licensed premises gaming machine permit <i>((if you choose this option then please complete sections B, D and E)</i></p> <p>d) Apply to vary an existing licensed premises gaming machine permit <i>(if you choose this option then please complete sections B, D and E)</i></p> <p>e) Apply to transfer an existing licensed premises gaming machine permit <i>(if you choose this option then please complete sections C, D and E)</i></p>	<input type="checkbox"/>     <input checked="" type="checkbox"/>  <input type="checkbox"/>												
<p><b>SECTION B – Application for grant (includes <u>conversion</u>, <u>new</u> and <u>variation</u> applications)</b></p> <p>2. How many gaming machines are you currently authorised to provide and if this is a new or variation application, how many do you wish to provide? (please complete the boxes in the table)</p> <table border="1" style="margin-left: auto; margin-right: auto; border-collapse: collapse; text-align: center;"> <thead> <tr> <th style="padding: 5px;">Category machine</th> <th style="padding: 5px;">Number currently authorised to provide</th> <th style="padding: 5px;">Number wish to provide (new or variation)</th> </tr> </thead> <tbody> <tr> <td style="padding: 5px;">C</td> <td style="padding: 5px;">12</td> <td style="padding: 5px;">8</td> </tr> <tr> <td style="padding: 5px;">D</td> <td style="padding: 5px;"></td> <td style="padding: 5px;">12</td> </tr> <tr> <td style="padding: 5px;">Total</td> <td style="padding: 5px;">12</td> <td style="padding: 5px;">20</td> </tr> </tbody> </table> <p>3. If you are currently authorised to provide more than 2 machines, please provide your existing Section 34 Gaming Act 1968 permit, or provide reasons stating why it cannot be provided.</p> <p style="text-align: right;">Existing permit provided* <input type="checkbox"/></p> <p><i>(reasons why existing permit cannot be provided)</i> .....</p> <p>.....</p>	Category machine	Number currently authorised to provide	Number wish to provide (new or variation)	C	12	8	D		12	Total	12	20	
Category machine	Number currently authorised to provide	Number wish to provide (new or variation)											
C	12	8											
D		12											
Total	12	20											

\* Please keep a copy of your existing permit on the premises to which it relates.

**NOTIFICATION OF 2 OR LESS GAMING MACHINES or  
GAMING MACHINE PERMIT APPLICATIONS (i.e. for greater than 2 machines) for:  
CONVERSION / NEW / VARIATION / TRANSFER**

(FOR USE BY PREMISES LICENSED TO SUPPLY ALCOHOL FOR CONSUMPTION ON THE PREMISES)

**Section C – Application for permit transfer (i.e. where a transfer has been requested for the Licensing Act 2003 premises licence)**

4. Name of person requesting the transfer

.....

5. Confirmation that an application to transfer the relevant Licensing Act 2003 Premises Licence has been:

Requested

Granted

6. Please provide your existing permit, or provide reasons stating why it cannot be provided

Existing permit provided

Reasons why existing permit cannot be provided

.....

.....

**Section D – General Information**

7. Name of Premises..... BOWLPLEX

8. Address of Premises... BIRMINGHAM ROAD  
CASTLE GATE PARK, DUDLEY, WEST MIDLANDS DY1 4TA

9. Telephone number of Premises... 01384 213413

10. Name of existing Premises Licence holder

BOWLPLEX LTD PLC

11. Address of Premises Licence holder (if different from 8 above)

DEAN PARK HOUSE, 8-10 DEAN PARK CRESCENT  
BOURNEMOUTH DORSET BH1 1HL

12. Telephone number (daytime) of Premises Licence holder

01202 - 638200

13. E-mail address of Premises Licence holder (where available)

.....

14. Name, address, telephone and e-mail of agent (e.g. solicitor) if submitted on behalf of the applicant

ELAINE BROTHERIDGE

Town and County Leisure Ltd.

Unit 6, Longacre Trading Estate,

Longacre,

Birmingham,

B7 5JD

Tel Number: 0121 327 6984

www.townandcounty.co.uk

Vat Number: GB907123401

15. Licensing Act 2003 Premises Licence Reference (i.e. number)

DY/SS/0514

NOTIFICATION OF 2 OR LESS GAMING MACHINES or  
GAMING MACHINE PERMIT APPLICATIONS (i.e. for greater than 2 machines) for:  
CONVERSION / NEW / VARIATION / TRANSFER

(FOR USE BY PREMISES LICENSED TO SUPPLY ALCOHOL FOR CONSUMPTION ON THE PREMISES)

Section E – Fee and Signature(s) DUDLEY MBC

I enclose a sum of £ 100\* (cheques should be made payable to)

*I understand that I must comply with the Gaming Machine Code of Practice for Alcohol Licensed Premise Permits and Permissions issued by the Gambling Commission. (see guidance note 8)*

Please note: It is an offence under section 342 of the Gambling Act 2005 if a person, without reasonable excuse, gives to a licensing authority for a purpose connected with that Act information which is false or misleading.

Dated ..... 18th NOVEMBER 2010 .....

Signed (by or on behalf of Licensing Act 2003 Premises Licence holder)..... PP  .....

Print Name..... ELAINE BROTHWICK .....

\* Please see the enclosed 'Permit Fees' sheet.

**Official Use Only**

Date of receipt: .....

Signature and name of staff who received: .....

Date of receipt of fee: .....

Application accepted / returned (please delete as appropriate)

Date of premises licence (Licensing Act 2003) transfer (if applicable): .....

Licence reference (if applicable) .....



## Licensed Premises Gaming Machine Permit

No: **DY/55/0514**

This licensed premises gaming machine permit authorises **BOWLPLEX LTD PLC, DEAN PARK HOUSE, 8-10 DEAN PARK CRESCENT, BOURNEMOUTH, DORSET, BH1 1HL**

To make gaming machines, of the category and number specified below, available for use on the following premises

**BOWLPLEX  
BIRMINGHAM ROAD  
CASTLE GATE PARK,  
DUDLEY  
WEST MIDLANDS,  
DY1 4TA**

Number of Category C gaming machines authorised by this permit **12**  
*(if no machines of this category are authorised, insert '0')*

Number of Category D gaming machines authorised by this permit: **0**  
*(if no machines of this category are authorised, insert '0')*

Date on which this permit takes effect: **7<sup>th</sup> JANUARY 2010**  
This permit is issued by

**Dudley Metropolitan Borough Council,  
Licensing Section,  
5, Ednam Road,  
Dudley,  
DY1 1HL**

Signed.....

Dated...**11<sup>th</sup> January 2010**

\*CCCK  
 ●CAC D

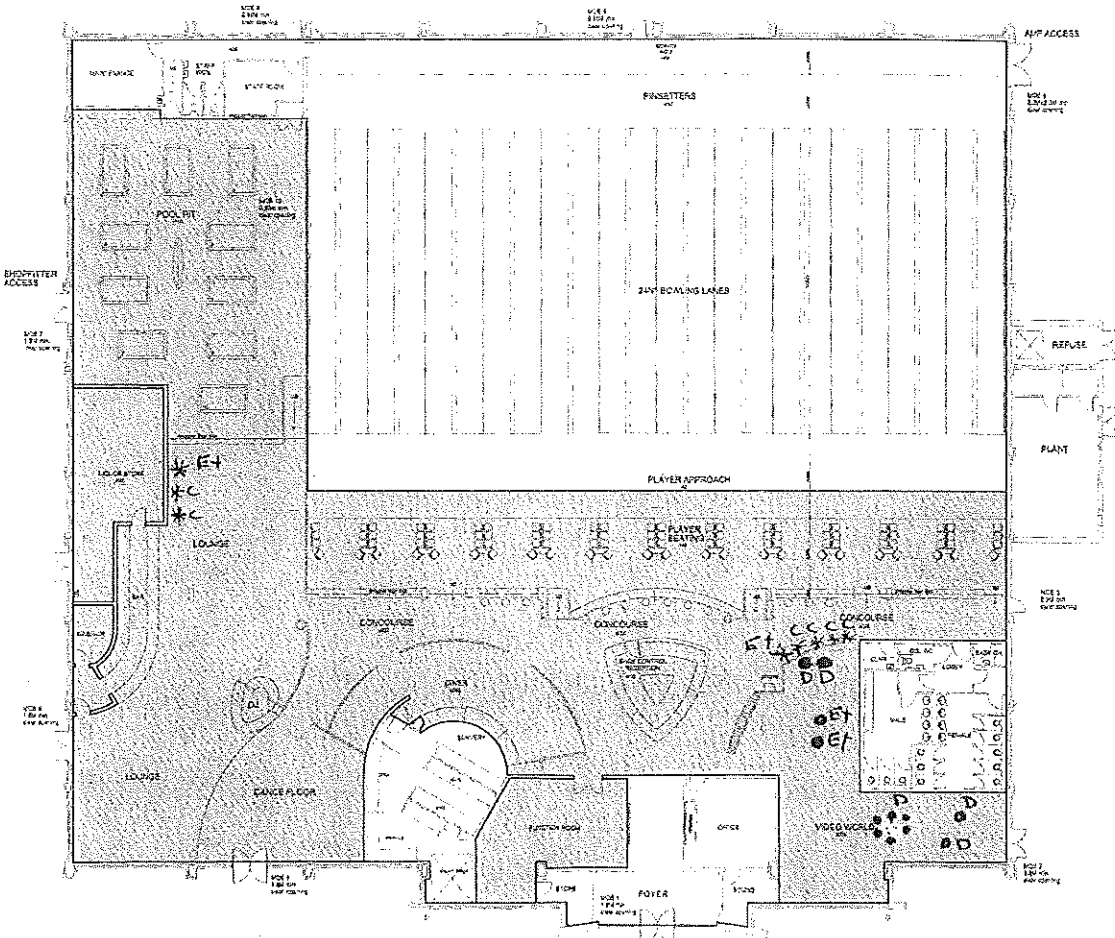

GENERAL NOTES:  
 1. ALL WORK SHALL BE IN ACCORDANCE WITH THE LATEST EDITIONS OF THE BRITISH STANDARDS INSTITUTION'S SPECIFICATIONS FOR CONSTRUCTION MATERIALS AND METHODS.  
 2. THE CONTRACTOR SHALL BE RESPONSIBLE FOR OBTAINING ALL NECESSARY PERMITS AND APPROVALS FROM THE LOCAL AUTHORITY.  
 3. ALL DIMENSIONS SHALL BE AS SHOWN UNLESS OTHERWISE SPECIFIED.  
 4. THE CONTRACTOR SHALL BE RESPONSIBLE FOR OBTAINING ALL NECESSARY PERMITS AND APPROVALS FROM THE LOCAL AUTHORITY.  
 5. ALL WORK SHALL BE IN ACCORDANCE WITH THE LATEST EDITIONS OF THE BRITISH STANDARDS INSTITUTION'S SPECIFICATIONS FOR CONSTRUCTION MATERIALS AND METHODS.  
 6. THE CONTRACTOR SHALL BE RESPONSIBLE FOR OBTAINING ALL NECESSARY PERMITS AND APPROVALS FROM THE LOCAL AUTHORITY.  
 7. ALL DIMENSIONS SHALL BE AS SHOWN UNLESS OTHERWISE SPECIFIED.  
 8. THE CONTRACTOR SHALL BE RESPONSIBLE FOR OBTAINING ALL NECESSARY PERMITS AND APPROVALS FROM THE LOCAL AUTHORITY.  
 9. ALL WORK SHALL BE IN ACCORDANCE WITH THE LATEST EDITIONS OF THE BRITISH STANDARDS INSTITUTION'S SPECIFICATIONS FOR CONSTRUCTION MATERIALS AND METHODS.  
 10. THE CONTRACTOR SHALL BE RESPONSIBLE FOR OBTAINING ALL NECESSARY PERMITS AND APPROVALS FROM THE LOCAL AUTHORITY.  
 11. ALL DIMENSIONS SHALL BE AS SHOWN UNLESS OTHERWISE SPECIFIED.  
 12. THE CONTRACTOR SHALL BE RESPONSIBLE FOR OBTAINING ALL NECESSARY PERMITS AND APPROVALS FROM THE LOCAL AUTHORITY.  
 13. ALL WORK SHALL BE IN ACCORDANCE WITH THE LATEST EDITIONS OF THE BRITISH STANDARDS INSTITUTION'S SPECIFICATIONS FOR CONSTRUCTION MATERIALS AND METHODS.  
 14. THE CONTRACTOR SHALL BE RESPONSIBLE FOR OBTAINING ALL NECESSARY PERMITS AND APPROVALS FROM THE LOCAL AUTHORITY.  
 15. ALL DIMENSIONS SHALL BE AS SHOWN UNLESS OTHERWISE SPECIFIED.

1:1000 SCALE (OVERALL)  
 1:100 SCALE (DETAILS)

**WDG**  
 Westover Design Group  
 ARCHITECTURE  
 INTERIORS  
 140-142 BROADWAY  
 NEW YORK, NY 10038  
 TEL: (212) 512-2000  
 FAX: (212) 512-2001

OWNER:  
 BOWLEXPLEX, PLC.  
 ADDRESS:  
 BOWLEXPLEX  
 TEN-PIN BOWLING CENTRE  
 CASTLE GATE  
 BUSINESS PARK  
 BUDLEY

Drawn by:  
**PROPOSED FLOOR PLAN  
 FLOOR PLAN**

LICENSING PLAN

Scale: 1:1000 Date: 12/2000  
 1:100 Scale: 12/2000  
 1:50 Scale: 12/2000  
 1:20 Scale: 12/2000  
 1:10 Scale: 12/2000

2956	L01b
------	------