

**GAMING MACHINE PERMIT APPLICATIONS FOR MORE THAN 2 MACHINES:
CONVERSION / NEW / VARIATION / TRANSFER**

(FOR USE BY PREMISES LICENSED TO SUPPLY ALCOHOL FOR CONSUMPTION ON THE PREMISES)

Please refer to guidance notes at the back of this form before completing

To: Dudley Metropolitan Borough Council
3 St James's Road , Dudley , DY1 1HZ

<p>SECTION A – What do you want to do?</p> <p>1. Please indicate what you would like to do</p> <p>a) Apply to convert an existing Section 34 permit issued under the Gaming Act 1968, into a licensed premises gaming machine permit where you want more than 2 gaming machines <i>(if you choose this option then please complete sections B, D and E)</i></p> <p>b) Apply for a new licensed premises gaming machine permit where you want more than 2 gaming machines <i>(if you choose this option then please complete sections B, D and E)</i></p> <p>c) Apply to vary an existing licensed premises gaming machine permit <i>(if you choose this option then please complete sections B, D and E)</i></p> <p>d) Apply to transfer an existing licensed premises gaming machine permit <i>(if you choose this option then please complete sections C, D and E)</i></p>	<p><input type="checkbox"/></p> <p>X</p> <p><input type="checkbox"/></p> <p><input type="checkbox"/></p> <p><input type="checkbox"/></p>												
<p>SECTION B – Application for grant (includes <u>conversion</u>, <u>new</u> and <u>variation</u> applications)</p> <p>2. How many gaming machines are you currently authorised to provide and if this is a new or variation application, how many do you wish to provide? (please complete the boxes in the table)</p> <table border="1" style="margin-left: auto; margin-right: auto; border-collapse: collapse; text-align: center;"> <thead> <tr> <th style="padding: 5px;">Category machine</th> <th style="padding: 5px;">Number currently authorised to provide</th> <th style="padding: 5px;">Number wish to provide (new or variation)</th> </tr> </thead> <tbody> <tr> <td style="padding: 5px;">C</td> <td style="padding: 5px;">2</td> <td style="padding: 5px;">3</td> </tr> <tr> <td style="padding: 5px;">D</td> <td style="padding: 5px;">0</td> <td style="padding: 5px;">0</td> </tr> <tr> <td style="padding: 5px;">Total:</td> <td style="padding: 5px;">2</td> <td style="padding: 5px;">3</td> </tr> </tbody> </table> <p>3. If you are currently authorised to provide more than 2 machines, please provide your existing Section 34 Gaming Act 1968 permit, or provide reasons stating why it cannot be provided.</p> <p style="text-align: right;">Existing permit provided*</p> <p><i>(Reasons why existing permit cannot be provided)</i></p> <p>.....</p>	Category machine	Number currently authorised to provide	Number wish to provide (new or variation)	C	2	3	D	0	0	Total:	2	3	<p><input type="checkbox"/></p>
Category machine	Number currently authorised to provide	Number wish to provide (new or variation)											
C	2	3											
D	0	0											
Total:	2	3											

***Please keep a copy of your existing permit on the premises to which it relates.**

**GAMING MACHINE PERMIT APPLICATIONS FOR MORE THAN 2 MACHINES:
CONVERSION / NEW / VARIATION / TRANSFER**

(FOR USE BY PREMISES LICENSED TO SUPPLY ALCOHOL FOR CONSUMPTION ON THE
PREMISES)

<p>Section C – Application for permit <u>transfer</u> <i>(i.e. where a transfer has been requested for the Licensing Act 2003 premises licence)</i></p> <p>4. Name of person requesting the transfer</p> <p>.....</p> <p>5. Confirmation that an application to transfer the relevant Licensing Act 2003 Premises Licence has been:</p> <table style="width: 100%;"><tr><td style="text-align: right;">Requested</td><td style="text-align: right;"><input type="checkbox"/></td></tr><tr><td style="text-align: right;">Granted</td><td style="text-align: right;"><input type="checkbox"/></td></tr></table> <p>6. Please provide your existing permit, or provide reasons stating why it cannot be provided</p> <table style="width: 100%;"><tr><td style="text-align: right;">Existing permit provided</td><td style="text-align: right;"><input type="checkbox"/></td></tr><tr><td style="text-align: right;">Reasons why existing permit cannot be provided</td><td></td></tr></table> <p>.....</p>	Requested	<input type="checkbox"/>	Granted	<input type="checkbox"/>	Existing permit provided	<input type="checkbox"/>	Reasons why existing permit cannot be provided		
Requested	<input type="checkbox"/>								
Granted	<input type="checkbox"/>								
Existing permit provided	<input type="checkbox"/>								
Reasons why existing permit cannot be provided									

<p>Section D – General Information</p> <p>7. NAME OF PREMISES: Corn Exchange</p> <p>8. ADDRESS OF PREMISES: Amblecote Rd, Brierley Hill, DY5 2YJ</p> <p>9. TELEPHONE NUMBER OF PREMISES: 01384 262753</p> <p>10. NAME OF EXISTING PREMISES LICENCE HOLDER: Spirit Group</p> <p>11. ADDRESS OF PREMISES LICENCE HOLDER: 107 Station Street, Burton on Trent, Staffordshire, DE14 1SZ</p> <p>12. DAYTIME TELEPHONE NUMBER OF PREMISES LICENCE HOLDER: 01283 545320</p> <p>13. E-MAIL ADDRESS OF PREMISES LICENCE HOLDER: UNKNOWN</p> <p>14. AGENT (E.G. SOLICITOR) IF SUBMITTED ON BEHALF OF THE APPLICANT: Gamestec Leisure , Low Lane , Horsforth , Leeds , LS18 4ER Telephone: 01132589495</p> <p>15. LICENSING ACT 2003 PREMISES LICENCE REFERENCE (I.E. NUMBER)</p>

GAMING MACHINE PERMIT APPLICATIONS FOR MORE THAN 2
MACHINES:
CONVERSION / NEW / VARIATION / TRANSFER

(FOR USE BY PREMISES LICENSED TO SUPPLY ALCOHOL FOR CONSUMPTION ON THE
PREMISES)

Section E – Fee and Signature(s)

I enclose a sum of (£150 cheques should be made payable Dudley Metropolitan Borough Council)

*I understand that I must comply with the Gaming Machine Code of Practice for Alcohol Licensed
Premise Permits and Permissions issued by the Gambling Commission. (see guidance note 8)*

*Please note: It is an offence under section 342 of the Gambling Act 2005 if a person, without reasonable
excuse, gives to a licensing authority for a purpose connected with that Act information which is false or
misleading.*

Dated...05 February 2009

Signed (by or on behalf of Licensing Act 2003 Premises Licence holder)

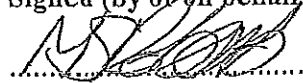

Print Name...Melanie Roberts

* If you wish to have more than 2 gaming machines then please check the fee payable.

Official Use Only

Date of receipt:

Name of staff member who received application form:

Date of receipt of fee:

Name of staff member who received fee:

Application accepted / returned (please delete as appropriate)

Date of premises licence (Licensing Act 2003) transfer (if applicable):

**GAMING MACHINE PERMIT APPLICATIONS FOR MORE THAN 2 MACHINES:
CONVERSION / NEW / VARIATION / TRANSFER**

Guidance notes:

1. This form is to be used for the **conversion of an existing Section 34** gaming machine permit under the Gaming Act 1968, or for a **new application, variation or transfer** of a alcohol licensed premises gaming machine permit under the Gambling Act 2005.
1. The premises must be licensed under the Licensing Act 2003 to sell alcohol for consumption on the premises, without the requirement that alcohol is served only with food and there must be a bar for serving alcohol to customers on the premises.
2. The gaming machines must be located on these licensed premises.
3. A 'Premises Licence holder' is a person holding a Premises Licence under the Licensing Act 2003.
4. There is no statutory limit to the number of machines, which may be applied for although the licensing authority has some discretion in this regard.
5. The permit's duration is indefinite as it is linked to the Licensing Act 2003 Premises Licence. There is a first annual fee payable within 30 days of the date of issue of the permit and an annual fee payable after that before each anniversary of the date of issue of the permit. Failure to pay the annual fee may result in the cancellation of the permit. The annual fee is £50 (to be confirmed). There are no annual fees payable for 2 machines or less.
6. Two types of gaming machines may be located in alcohol licensed premises. These are:
 - Category C: Maximum stake = 50p / Maximum prize = £35
 - Category D: Maximum stake = 10p or 30p non-monetary / Maximum prize = £5 cash or £8 non-monetary
7. All alcohol licensed premises which provide gaming machines for use on the premises must comply with any relevant Code of Practice issued by the Gambling Commission under Section 24 of the Gambling Act 2005. The Gaming Machine Code of Practice for Alcohol licensed premises permits and permissions is available via the Gambling Commission's website at: <http://www.gamblingcommission.gov.uk/> Should you be unclear as to the provisions of the code of practice please contact the Gambling Commission.
8. This licensing authority must notify the applicant of its grant / refusal of the application for a permit as soon as is reasonable practicable after that decision to grant / refuse has been made.

Pub Co: Spirit
Mgr: Bryan Wilson

Site Plan

House No:
Acc Man:

Date: 4th Feb '09

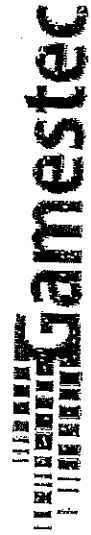

Site Name: Corn Exchange

KEY	AWP	Digital Music	SWP	Video	Tournament	Pool	CJD	W/Box	Cigs M/c	Sound	Gamesnet	ATM	Change Machine
	AWP	Digital Music	SWP	Video	Tournament	Pool	CJD	W/Box	Cigs M/c	Sound	Gamesnet	ATM	Change Machine

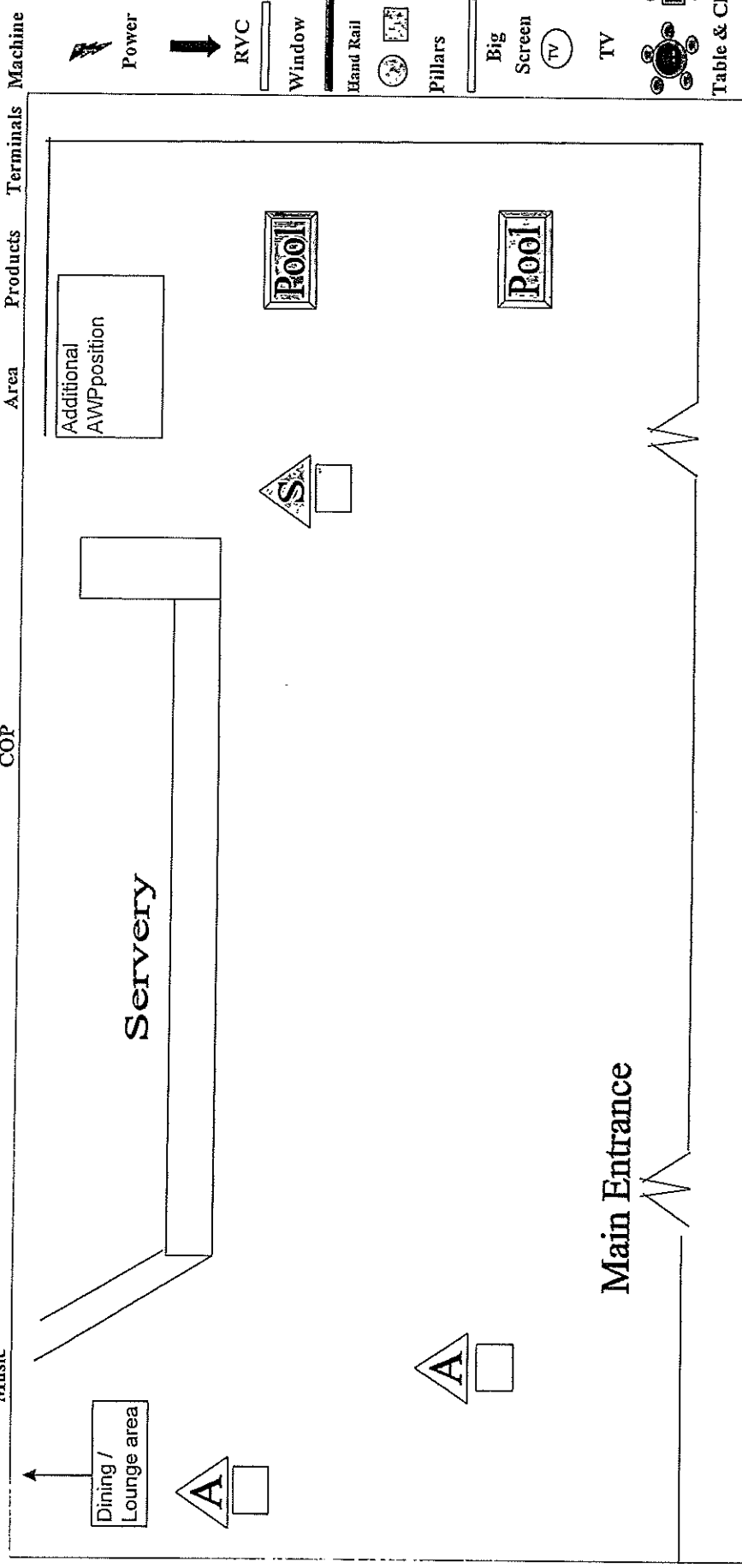

Action Required / Additional Comments: 1.